

P&P

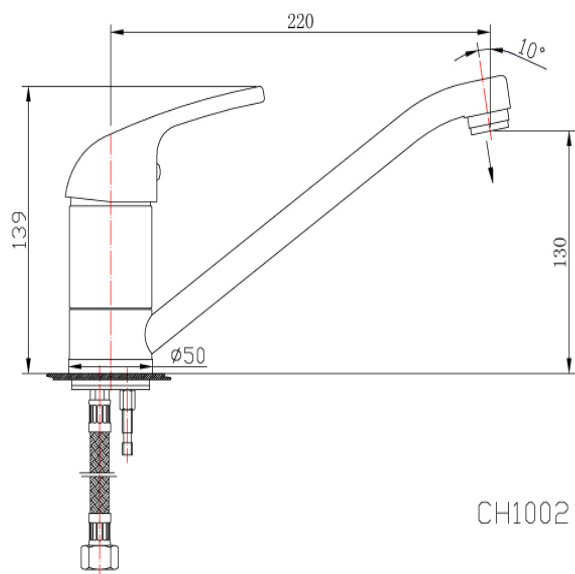

CH1002



Available in



Matt Black  
PM1001SW-B

## Ruby Swivel Sink Mixer

PM1001SW

### Information

**Finish:** Chrome

**Material:** Brass

**Cartridge:** 40mm Cartridge

**Working Pressure:** 150-500 kpa

**Operating Temperature:** 1°C to 70°C

**WELS Reg Number:** T37873 (5 Star 5.5 L/min)

### Maintenance and Care

- Do not use harsh detergents or products that contain chloride & halides.
- Do not use abrasive, cream or citrus based cleaners or hydrochloric acid.
- Surface should be cleaned only with a mild detergent that must be rinsed off.
- It is suggested to only clean with warm water and a soft cloth.
- Damage caused by the wrong cleaning methods used will void warranty.

Please visit <https://www.aclco.com.au/warranty.html> to view the full warranty